



LCD DISPLAY

quick start guide

400EX(n) 460EX(n) 550EX(n)

Introduction

Package Contents



Please make sure the following items are included with your LCD Display.

If any items are missing, contact your dealer.

Contact a local dealer to buy optional items.



This stand is not for the Floor Standing Type.

Checking the Contents of the Package

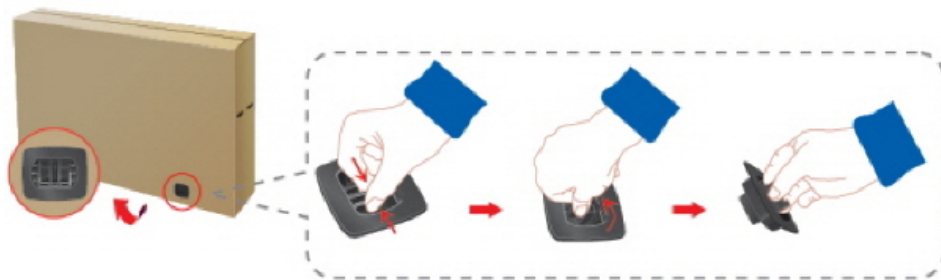

Remove the lock from the package box, as shown in the figure above.



Lift up the package box by holding the grooves on both sides of the package box.

Check the contents of the package.

Remove the Styrofoam and vinyl cover.



- After unpacking the package, make sure to check the contents of the package.
- Make sure to keep the package box for transporting the product in the future.
- After unpacking, you may use the lower part of the package box as a temporary stand for product test or operation check.

Unpacking



LCD Display

Manuals



Quick Setup Guide



Warranty Card



User's Guide

(Not available in all locations)



MagicInfo Software CD,
MagicInfo Manual CD
(Applicable to the **EXn**
model only)

Cables



Power Cord



D-Sub Cable

Others



Remote Control
(BP59-00138A)



Batteries (AAA X 2)
(Not available in all locations)



HOLDER-WIRE 2EA
(BN61-05373A)

Sold separately



LAN Cable



USB Cable



RGB to BNC Cable

(Applicable to the EXn model only)

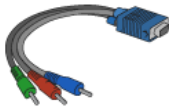

RGB to Component Cable



Network Box

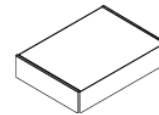

Wall Mount KIT

RGB to AV Cable

(Applicable to the EX model only)

Your LCD Display

Front



1 SOURCE button

Switches from PC mode to Video mode. Selects the input source that an external device is connected to.

[PC] → [AV] → [Component] → [HDMI] → [MagicInfo]

Note

For an EX model,

- **MagicInfo** can only be enabled when a network box is connected.
- The **HDMI** port and network box cannot be connected at the same time.

- 2 (Power) button

Use this button for turning the LCD Display on and off.

- 3 Brightness Sensor

Automatically detects the surrounding brightness.

- 4 Power indicator

Shows PowerSaver mode by blinking green



See PowerSaver described in the manual for further information regarding power saving functions. For energy conservation, turn your LCD Display OFF when it is not needed or when leaving it unattended for long periods.

- 5 Remote Control Sensor

Aim the remote control towards this spot on the LCD Display.

Rear



For detailed information concerning cable connections, refer to Connecting Cables under Setup. The LCD Display's configuration at the back may vary slightly depending on the model.

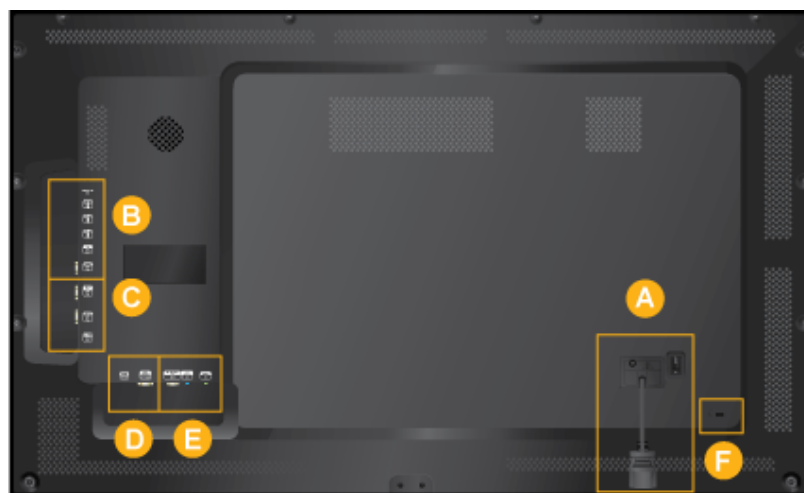

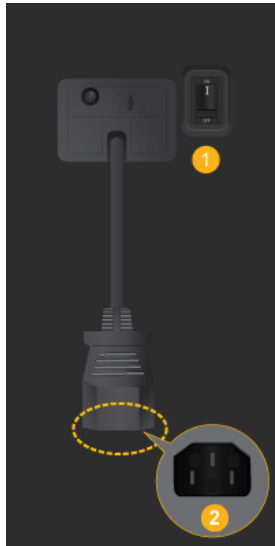

① *POWER SW ON [|] / OFF*

Switches the LCD Display On/Off.

② *POWER*

The power cord plugs into the LCD Display and the wall outlet.

B **Note**

Applicable to the **EXn** model only.

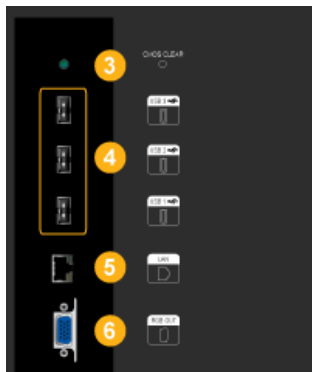

③ *CMOS CLEAR*

Resets **MagicInfo**.

④ *USB 1 / 2 / 3 (USB Connection Terminal)*

Keyboard / Mouse, Mass Storage Device Compatible.

⑤ *LAN (LAN Connection Terminal)*

Connects to a LAN cable to allow Internet or network access in **MagicInfo** mode.

⑥ *RGB OUT*

MagicInfo video output port

C

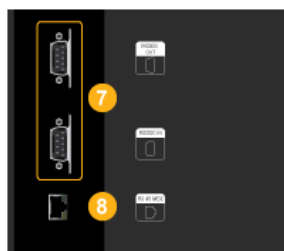

⑦ *RS232C OUT / IN (RS232C Serial PORT)*

MDC(Multiple Display Control) Program Port

⑧ *RJ 45 MDC (MDC PORT)*

MDC(Multiple Display Control) Program Port

D

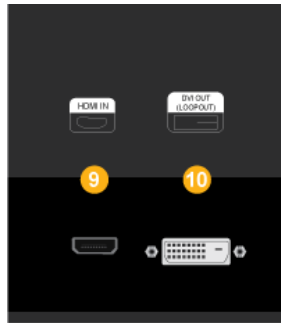

9 HDMI IN

- Connect the HDMI terminal at the back of your LCD Display to the HDMI terminal of your digital output device using a HDMI cable.
- Up to HDMI 1.0 can be supported.

10 DVI OUT(LOOPOUT)

- Connect a monitor to another monitor through a DVI, DVI to HDMI cable.
- Connect the [DVI OUT(LOOPOUT)] port on the monitor to the [HDMI IN] port on the other monitor using the DVI to HDMI cable.
- HDMI and network signals sent via the [DVI OUT(LOOPOUT)] port are displayed on the second display which has the DVI IN port.



Note

A maximum of 6 monitors can be connected to DVI-Loopout. However, up to 10 monitors can be connected in Full HD mode depending on the type of cable or signal equipment connected.

E



11 RGB / COMPONENT / AV IN

- Connect the [RGB/COMPONENT/AV IN] port of the product to the RGB port of the PC using the D-SUB cable.
- Connect the [RGB / COMPONENT / AV IN] port on the monitor to the Component port on the external device using the RGB to Component cable.
- Connect the [RGB / COMPONENT / AV IN] port on the monitor to the BNC port on the PC using the RGB to BNC cable.
- Connect the [RGB / COMPONENT / AV IN] port on the monitor to the AV port on the external device using the RGB to AV cable.

12 *AUDIO IN*

Connect the [AUDIO IN] port on the monitor to the audio output port on the PC or on the external device using an audio cable.

13 *AUDIO OUT*

Connect a headphone or an External speaker.

 **Note**

The [AUDIO OUT] port is only supported for 460EX(n) and 550EX(n) models.

F



Kensington Lock

A Kensington Lock is an anti-theft device that enables users to lock the product so that they can safely use it in public locations. Since the shape and usage of the locking device may differ depending on the model and the manufacturer, refer to the User Manual supplied with the locking device for more information.

 **Note**

You must purchase the Kensington Lock separately.

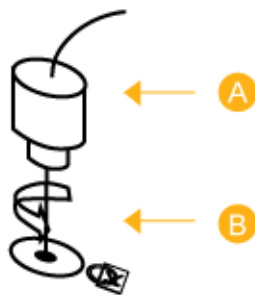

To lock the product, follow these steps:

1. Wrap the Kensington lock cable around a large, stationary object such as a desk or chair.
2. Slide the end of the cable with the lock attached through the looped end of the Kensington lock cable.
3. Insert the locking device into the Kensington slot on the Monitor (**A**).
4. Lock the lock (**B**).

 **Note**

- These are general instructions. For exact instructions, see the User Manual supplied with the locking device.

- You can purchase the locking device from an electronics store, an online shop, or our service center.

 **Note**



See Connecting Cables for further information regarding cable connections.

Remote Control

 **Note**

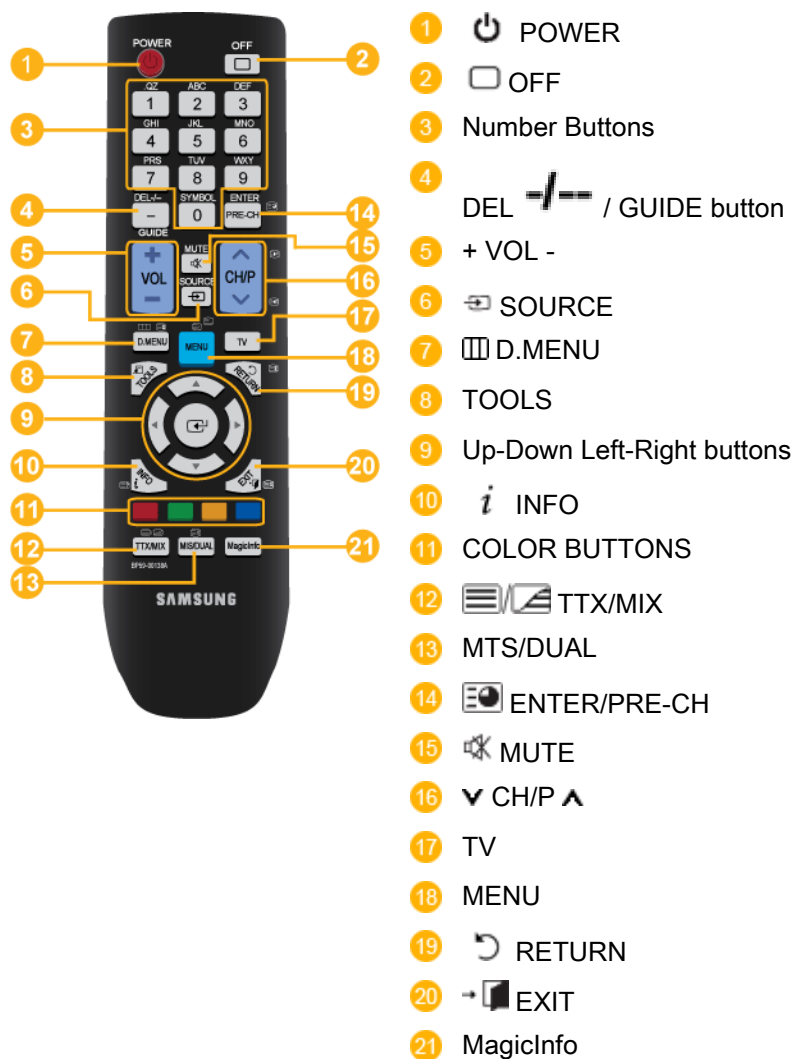
The performance of the remote control may be affected by a TV or other electronic device operating near the LCD Display, causing a malfunction due to interference with the frequency.



- | | |
|--|---|
| 1.  POWER | Turns the product On. |
| 2.  OFF | Turns the product Off. |
| 3. Number Buttons | Used to enter the password during the OSD adjustment or to use MagicInfo. |
| | Press to change the channel. |

4. DEL  / GUIDE button

The "-" button is used to select Digital channels.

Electronic Program Guide (EPG) display.

- This function does not work for this LCD Display.

5. + VOL -

Adjusts the audio volume.

6.  SOURCE

Selects a connected external input source or **MagicInfo** mode.

Press the button to change the input signal SOURCE.

Changing the SOURCE is only allowed for external devices that are connected to the LCD Display at the time.

7.  D.MENU

DTV menu display

- This function does not work for this LCD Display.

8. TOOLS

Use to quickly select frequently used functions.

- This function does not work for this LCD Display.

9. Up-Down Left-Right buttons

Moves from one menu item to another horizontally, vertically or adjusts selected menu values.

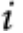
10.  INFO

Current picture information is displayed on the upper left corner of the screen.

11. COLOR BUTTONS

Press to add or delete channels and to store channels to the favorite channel list in the "Channel List" menu.

- This function does not work for this LCD Display.

12.  TTX/MIX

TV channels provide written information services via teletext.

- Teletext Buttons



- This function does not work for this LCD Display.

13. MTS/DUAL







MTS-

You can select MTS (Multichannel Television Stereo) mode.

	Audio Type	MTS/S_Mode	Default
FM Stereo	Mono	Mono	Manual
	Stereo	Mono ↔ Stereo	Change
	SAP	Mono ↔ SAP	Mono

DUAL-

STEREO/MONO, DUAL I / DUAL II and MONO/NICAM MONO/NICAM STEREO can be operated depending on the broadcasting type by using the DUAL button on the remote control while watching TV.

- 14.  ENTER/PRE-CH
 - This function does not work for this LCD Display.This button is used to return to the immediately previous channel.
 - This function does not work for this LCD Display.
- 15.  MUTE
 - This function does not work for this LCD Display.Pauses (mutes) the audio output temporarily. This is displayed on the lower left corner of the screen. The audio comes back on if MUTE or - VOL + is pressed in the Mute mode.
- 16.  CH/P 
 - This function does not work for this LCD Display.In **TV** mode, selects TV channels.
- 17. TV
 - This function does not work for this LCD Display.Selects the TV mode directly.
- 18. MENU
 - This function does not work for this LCD Display.Opens the on-screen menu and exits from the menu or closes the adjustment menu.
- 19.  RETURN
 - This function does not work for this LCD Display.Returns to the previous menu.
- 20.  EXIT
 - This function does not work for this LCD Display.Exits from the menu screen.
- 21. MagicInfo
 - This function does not work for this LCD Display.MagicInfo Quick Launch Button.

 **Note**

This button is disabled for products that do not support **MagicInfo**.

Connections

Connecting a Computer

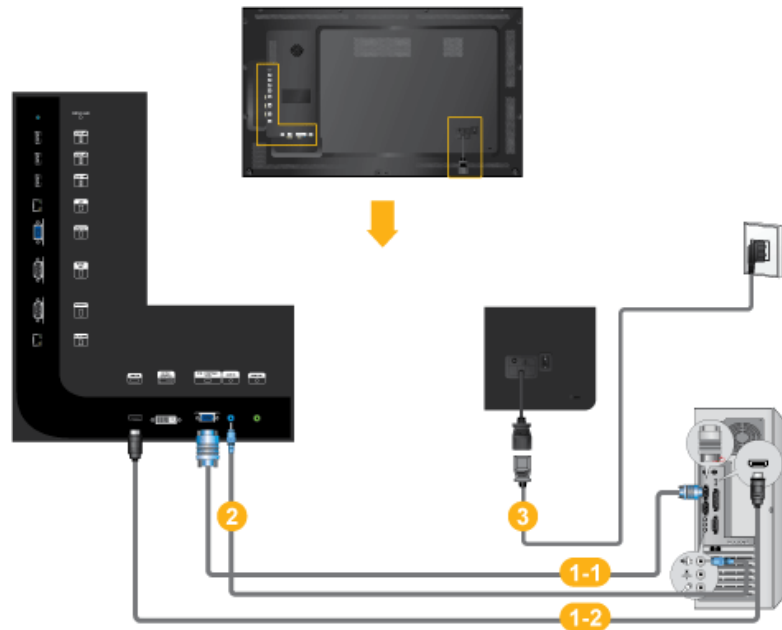

- 1 There are several ways to connect the computer to the monitor. Choose one from the following options.

1-1 Using the D-sub (Analog) connector on the video card.

- Connect the D-sub to the 15-pin, [RGB / COMPONENT / AV IN] port on the back of your LCD Display and the 15 pin D-sub Port on the computer.

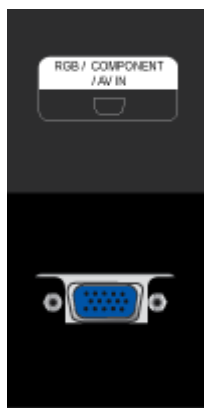

1-2 Using the HDMI (digital) output on the graphics card.

- Connect the [HDMI IN] port on the LCD Display to the HDMI port on the PC using the HDMI cable.

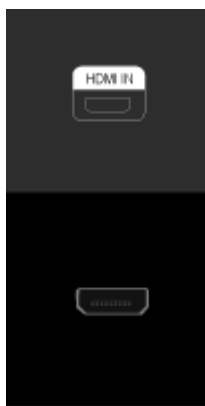

 **Note**

When the HDMI cable to the PC, ensure that you select **HDMI** from both the **Source List** and **Edit Name** before selecting **PC** or **DVI** device so that normal PC screen and sound can be outputted. Note that sound is only available when connected according to the option **2** that follows.

- 2** Connect the Audio cable for your LCD Display to the Audio port on the back of the LCD Display.
- 3** Connect the power cord for your LCD Display to the Power port on the back of the LCD Display. Turn on the power switch.

 **Note**

- Turn on both your computer and the LCD Display.
- Contact a local SAMSUNG Electronics Service Center to buy optional items.

Connecting to Other devices

 **Note**

- AV input devices such as DVD players, VCRs or camcorders as well as your computer can be connected to the LCD Display. For detailed information on connecting AV input devices, refer to the contents under Adjusting Your LCD Display.
- The LCD Display 's configuration at the back may vary slightly depending on the LCD Display model.

Connecting an External Monitor

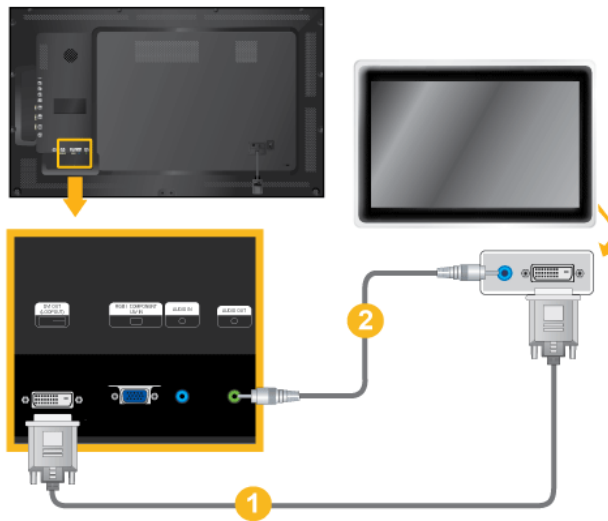

1. Connect between the [DVI OUT(LOOPOUT)] port on the LCD Display and the input port on another monitor using a DVI cable.
2. Connect between the [AUDIO OUT] port on the LCD Display and the audio input port on another monitor using a stereo cable.
3. Select DVI using the SOURCE button on the front of the LCD Display or on the remote control.

 **Note**

DVI OUT does not support HDCP.

Connecting Using a RGB to AV Cable

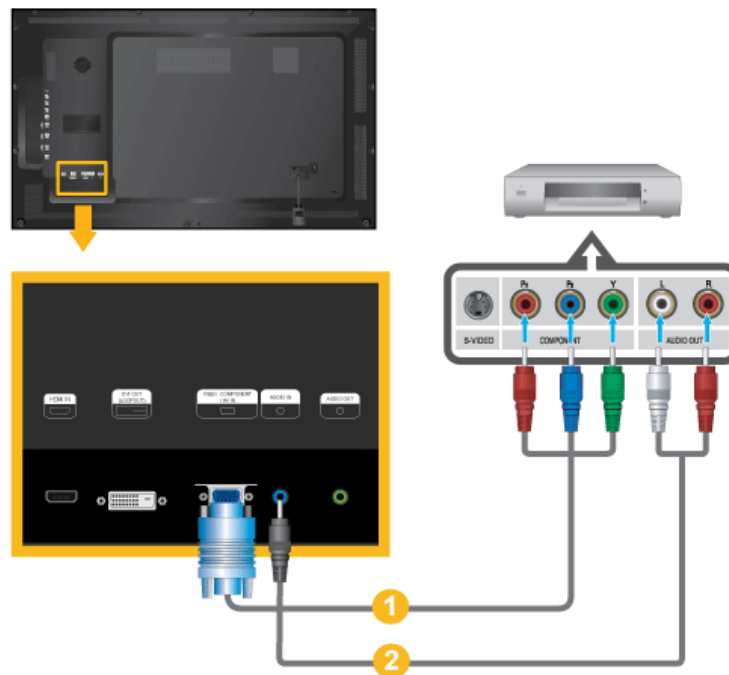

1. Connect the RGB to AV cable to the [RGB/COMPONENT/AV IN] port on the monitor.

2. Connect a set of audio cables between the [AUDIO IN] on the LCD Display and the AUDIO OUT jacks on the DVD player.

 **Note**

- Select **AV** for the connection to a DVD player using the SOURCE button on the front of the LCD Display or on the remote control.
- Then, start the DVD Player with a DVD disc inserted.
- A RGB to AV cable is optional.

Connecting Using a HDMI Cable



1. Connect input devices such as a Blu-Ray/DVD player to the [HDMI IN] terminal of the LCD Display using an HDMI cable.
2. Select **HDMI** using the SOURCE button on the front of the LCD Display or on the remote control.

 **Note**

In **HDMI** mode, only PCM format audio is supported.

Connecting Using a DVI to HDMI Cable

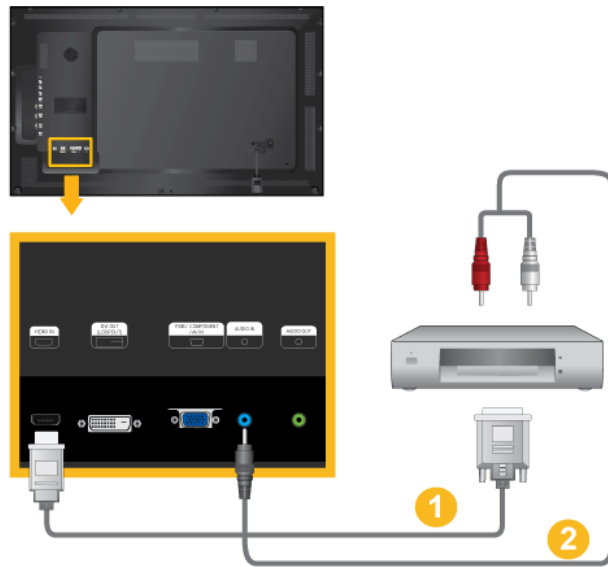

1. Connect the DVI output terminal of a digital output device to the [HDMI IN] terminal of the LCD Display using a DVI to HDMI cable.
2. Connect the red and white jacks of an RCA to stereo (for PC) cable to the same colored audio output terminals of the digital output device, and connect the opposite jack to the [AUDIO IN] terminal of the LCD Display.
3. Select **HDMI** using the SOURCE button on the front of the LCD Display or on the remote control.

Connecting a DVD Player

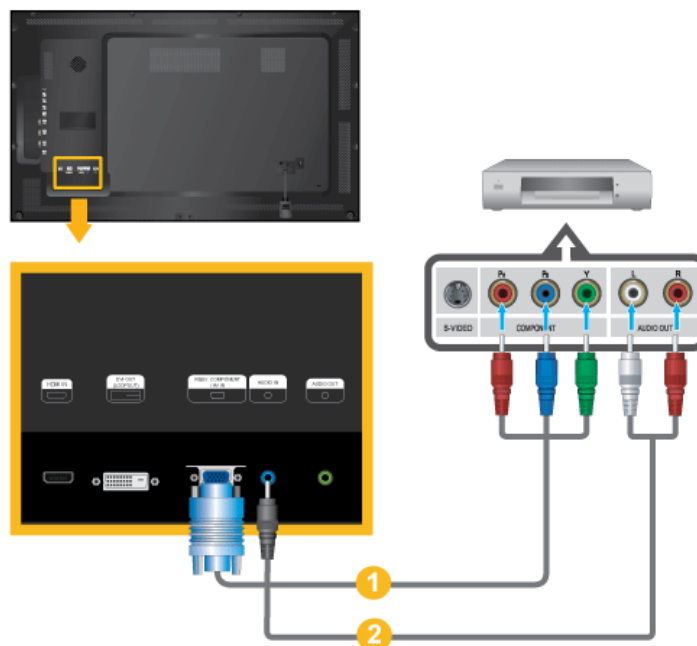

1. Connect a RGB to Component cable between the [RGB / COMPONENT / AV IN] port on the LCD Display and the P_R, Y, P_B jacks on the DVD player.

2. Connect a set of audio cables between the [AUDIO IN] on the LCD Display and the AUDIO OUT jacks on the DVD player.

 **Note**

- Select **Component** for the connection to a DVD player using the SOURCE button on the front of the LCD Display or on the remote control.
- Then, start the DVD Player with a DVD disc inserted.
- A **RGB to component** cable is optional.
- For an explanation of Component video, consult your DVD manual.

Connecting a DTV Set Top (Cable/Satellite) Box

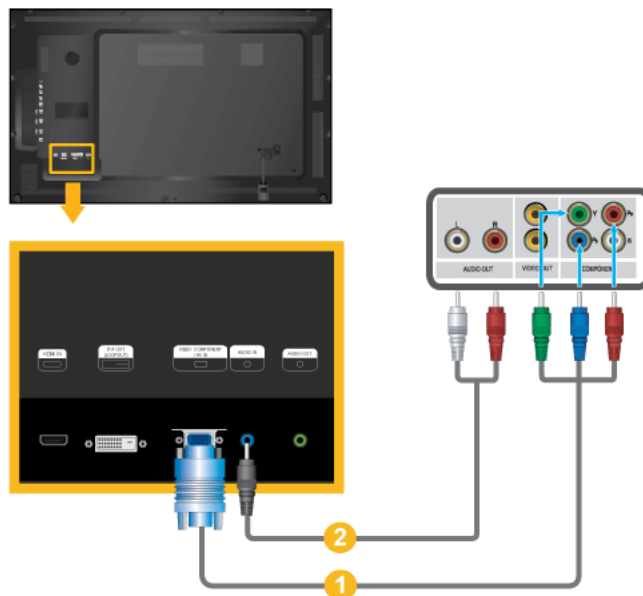

1. Connect a RGB to Component cable between the [RGB / COMPONENT / AV IN] port on the LCD Display and the P_R, Y, P_B jacks on the Set Top Box.
2. Connect a set of audio cables between the [AUDIO IN] on the LCD Display and the AUDIO OUT jacks on the Set Top Box.

 **Note**

- Select **Component** for the connection to a DTV Set Top Box using the SOURCE button on the front of the LCD Display or on the remote control.
- For an explanation of Component video, see your Set Top Box owner's manual.

Connecting to an Audio System



1. Connect a set of audio cables between the AUX L, R jacks on the AUDIO SYSTEM and [AUDIO OUT] on LCD Display.

Connecting a LAN Cable

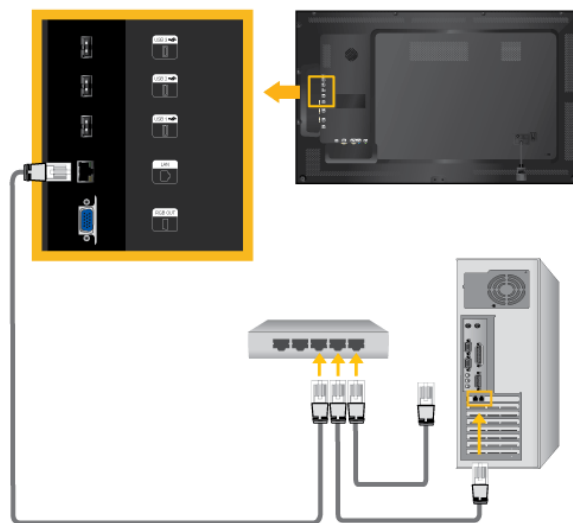

Connect the LAN cable.

 **Note**

Applicable to the EXn model only.

Connecting a USB devices

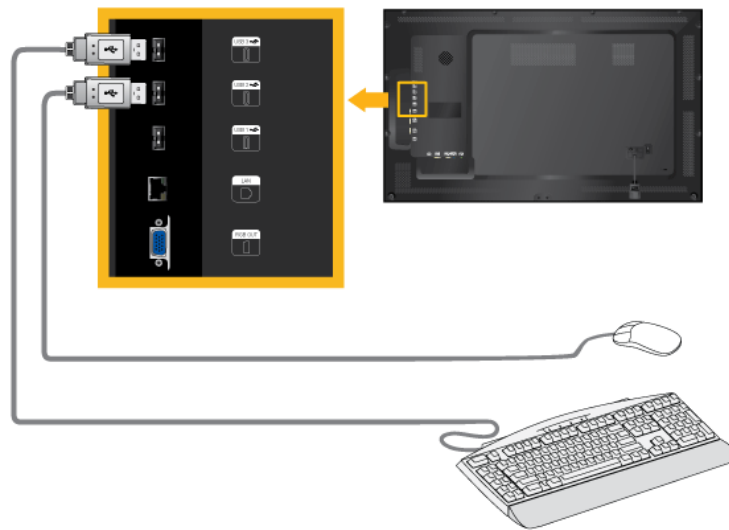

You can connect USB devices such as a mouse or keyboard.



Note

Applicable to the **EXn** model only.

Assembling the Cables

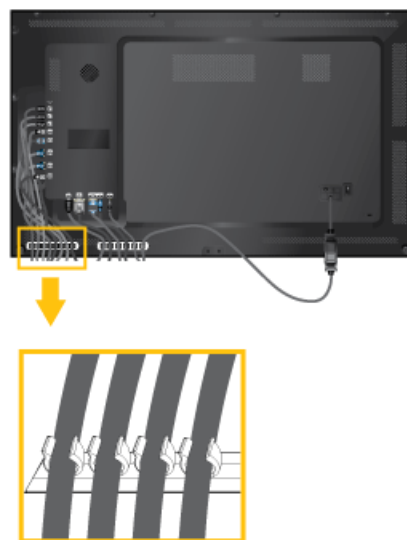

Note

Do not pull the cables too hard when arranging them. This may cause damage to the product's connection terminals.

Troubleshooting

Self-Test Feature Check



Check the following items yourself before calling for assistance. Contact a Service Center for problems that you cannot solve by yourself.

Self-Test Feature Check

1. Turn off both your computer and the LCD Display.
2. Unplug the video cable from the back of the computer.
3. Turn on the LCD Display.

The figure shown below ("No Signal") appears on a black background when the LCD Display is working normally even though no video signal is detected: While in the Self-Test mode, the LED power indicator remains green and the figure moves around on the screen.



4. Turn off your LCD Display and reconnect the video cable; then turn on both your computer and the LCD Display

If your LCD Display screen remains blank after using the previous procedure, check your video controller and computer system; your LCD Display is functioning properly.

Warning Messages

You can even view the screen at a resolution of 1920 x 1080. However, you will receive the following message for a minute; You can choose to change the screen resolution or stay in the current mode during that time. If the resolution is more than 85Hz, you will see the black screen because the LCD Display does not support over 85Hz.



Refer to Specifications > Preset Timing Modes for the resolutions or frequencies supported by the LCD Display.

Maintenance and Cleaning

- 1) Maintaining the LCD Display Case.

Clean with a soft cloth after disconnecting the power cord.



- Do not use benzene, thinner or other flammable substances.

2) Maintaining the Flat Panel Display Screen.

Clean with a soft cloth (cotton flannel).



- Never use acetone, benzene or thinner.
(They may cause flaws or deformation of the screen surface.)
- The user is responsible for any damage caused by using these substances.

Symptoms and Recommended Actions



Note

A LCD Display recreates visual signals received from the computer. Therefore, if there is a problem with the computer or the video card, this can cause the LCD Display to become blank, have poor coloring, become noisy, etc. In this case, first check the source of the problem, and then contact a Service Center or your dealer.

1. Check if the power cord and the video cables are properly connected to the computer.
2. Check if the computer beeps more than 3 times when booting.
(If it does, request service.)
3. If you installed a new video card or if you assembled the PC, check if you installed the Adaptor(video).
4. Check if the scanning ratio of the video screen is set to between 50 Hz ~ 85 Hz.
(Do not exceed 60Hz when using the maximum resolution.)
5. If you have problems in installing the Adaptor (video) driver, boot the computer in Safe Mode, remove the Display Adaptor in the "Control Panel -> System -> Device Administrator" and then reboot the computer to reinstall the Adaptor (video) driver.

Check List



Note

- The following table lists possible problems and their solutions. Before calling for assistance, check the information in this section to see if you can remedy any problems for yourself. If you do need assistance, please call the phone number on the Information section or contact your dealer.
- For more network-related information, refer to the MagicInfo Troubleshooting section.

Problems related to the Installation (PC Mode)



Note

Problems related to the LCD Display installation and their solutions are listed.

Q: The LCD Display screen flickers.

A: Check if the signal cable between the computer and the LCD Display is securely connected.

(Refer to Connecting a Computer)

Problems related to the Screen



Problems related to the LCD Display screen and their solutions are listed.

Q: The screen is blank and the power indicator is off.

A: Ensure that the power cord is firmly connected and the LCD Display is on.

(Refer to the Connecting a Computer)

Q: "No Signal" message.

A: Ensure that the signal cable is firmly connected to the PC or video sources.

(Refer to the Connecting a Computer)

A: Ensure that the PC or video sources are turned on.

Q: "**Not Optimum Mode**" message.

A: Check the maximum resolution and the frequency of the video Adaptor.

A: Compare these values with the data in the Preset Timing Modes Chart.

Q: The picture rolls vertically.

A: Check if the signal cable is securely connected. Re-connect it, if necessary.

(Refer to Connecting a Computer)

Q: The image is not clear; picture is blurred.

A: Run Frequency **Coarse** and **Fine** tuning.

A: Turn on again after removing all accessories (video extension cable, etc.)

A: Set the resolution and frequency to the recommended ranges.

Q: The picture image is unstable and shakes.

A: Check if the resolution and frequency set for the computer video card falls in the range supported by the LCD Display. If not, reset them referring to the current Information under the LCD Display menu and Preset Timing Modes.

Q: Ghost images are shown in the picture.

A: Check if the resolution and frequency set for the computer video card falls in the range supported by the LCD Display. If not, reset them referring to the current Information under the LCD Display menu and Preset Timing Modes.

Q: The image is too light or too dark.

A: Adjust the **brightness** and **contrast**.

(Refer to the **Brightness, Contrast**)

- Q: The screen color is inconsistent.
- A: Adjust color using **Custom** under OSD Color Adjustment menu.
- Q: The color image is distorted by dark shadows.
- A: Adjust color using **Custom** under OSD Color Adjustment menu.
- Q: The color white is poor.
- A: Adjust color using **Custom** under OSD Color Adjustment menu.
- Q: The Power Indicator blinks.
- A: The LCD Display is currently saving the changes made in the settings to the OSD memory.
- Q: The screen is blank and the power indicator light blinks every 0.5 or 1 seconds.
- A: The LCD Display is using its power management system. Press any key on the keyboard.
- Q: The screen is blank and it is blinking.
- A: If you see the "**TEST GOOD**" message on the screen when you pressing the MENU button, check the cable connection between the LCD Display and the computer to ensure that the connector is properly connected.

Problems related to Audio



Problems related to audio signals and their solutions are listed below.

- Q: No sound.
- A: Ensure that the audio cable is firmly connected to both the audio-in port on your LCD Display and the audio-out port on your sound card.
- (Refer to the Connecting a Computer)
- A: Check the volume level.
- Q: The sound level is too low.
- A: Check the volume level.
- A: If the volume is still too low after turning the control to its maximum, check the volume control on the computer sound card or software program.
- Q: The sound is too high or too low.
- A: Adjusts the **Treble** and **Bass** to the appropriate levels.

Problems related to the Remote Control



Problems related to the remote control and their solutions are listed.

- Q: The remote control buttons do not respond.
- A: Check the polarities (+/-) of the batteries.

- A: Check if the batteries are empty.
- A: Check if the power is on.
- A: Check if the power cord is securely connected.
- A: Check if a special fluorescent or neon lamp is on in the vicinity.

Q & A

Q: How can I change the frequency?

A: The frequency can be changed by reconfiguring the video card.



Note

That video card support can vary, depending on the version of the driver used. (Refer to the computer or the video card manual for details.)

Q: How can I adjust the resolution?

A: Windows XP:

Set the resolution in the Control Panel → Appearance and Themes → Display → Settings.

A: Windows ME/2000:

Set the resolution in the Control Panel → Display → Settings.

* Contact the video card manufacturer for details.

Q: How can I set the Power Saving function?

A: Windows XP:

Set the resolution in the Control Panel → Appearance and Themes → Display → Screen Saver.

Set the function in the BIOS-SETUP of the computer. (Refer to the Windows / Computer Manual).

A: Windows ME/2000:

Set the resolution at the Control Panel → Display → **Screen Saver**.

Set the function in the BIOS-SETUP of the computer. (Refer to the Windows / Computer Manual).

Q: How can I clean the outer case/LCD Panel?

A: Disconnect the power cord and then clean the LCD Display with a soft cloth, using either a cleaning solution or plain water.

Do not leave any detergent or scratches on the case. Do not let any water enter the LCD Display.

Q: How can I play the video?

A: The video supports the MPEG1 and WMV codecs only. Install the corresponding codec to play the video. Note that some of the codecs can be incompatible.

 **Note**

Before calling for assistance, check the information in this section to see if you can remedy any problems yourself. If you do need assistance, please call the phone number on the Information section or contact your dealer.