

Clarity SP Series



The next generation of visual performance in control rooms

The Clarity SP Series is the next generation of rear-projection DLP® displays designed for video-rich control rooms and corporate environments. The cubes combine very high resolution with SmoothPicture™ DLP technology for outstanding video performance.

With the SP Series, we have set a new standard in reliable, high resolution control room solutions. In these displays you will find all the hallmarks of our superior design and engineering including excellent image quality, easy set-up, minimized footprint, front and rear serviceability, superior seamless screen technology and easy maintenance, all rolled into a new and innovative design.

The SP Series is available in three sizes, two 4:3 displays with SXGA+ resolution plus a wide 70" display featuring 1080p high definition performance. The flexible design of the SP Series will fit the need of any control room, creating a highly functional, high quality digital display wall with a reasonable cost of ownership.

Features

Three sizes

50", 67" and 70" cubes

Superior resolution

SXGA+ to 1080p

Outstanding video performance

SmoothPicture™ DLP®

Intelligent operation

SiFi™ color and brightness control

Easy setup and service

Motorized image alignment,
full front and rear access

Open System

Operates with leading
image processors

Intelligent design

All SP Series cubes are intelligent digital displays, capable of monitoring and automatically adjusting both color and brightness balance through our revolutionary new patent-pending Set it and Forget it™ (SiFi) technology. SiFi is a proprietary system that enables brightness control and auto lamp switching through an easy-to-use remote interface. It helps users quickly and easily balance brightness, contrast and color across a wall of cubes.

The SP Series also incorporates user friendly set up and maintenance tools such as our patented six axis motor remote control image alignment, full front and rear serviceability and modular design for easy service.

Technology freedom

Based on our Open System architecture, each SP Series digital display operates with the leading multi-image processors and other content sources. With this architecture, organizations are completely free to choose the best components for any control center environment.

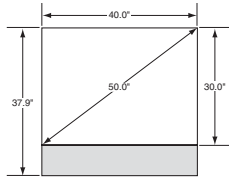

front

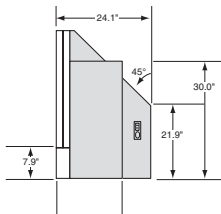

side

Clarity c50SP

Display resolution	SXGA+ (1400 x 1050)		
Aspect ratio (W:H)	4:3		
Screen dimensions	Diagonal 50" (127 cm) Width by Height 40" x 30" (101.6 cm x 76.2 cm)		
Cabinet dimensions (WxHxD)	40" x 37.9" x 24.1" (101.6 cm x 96.3 cm x 61.4 cm)		
Maximum stack height	6 high (requires supplemental support)		
Screen type	Wide-view (WV)	High-bright (HB)	
Full viewing angle	180°	180°	
Viewing angle (1/5 gain)	+/-70° V/H	+/-18° V; +/-48° H	
Viewing angle (1/2 gain)	+/-38° V/H	+/-10° V; +/-33° H	
Border (typical)	0		
Screen to screen gap	< 0.7 mm		
Brightness* (typical)			
100 watt	122 cd/m2 (36 ftL)	440 cd/m2 (128 ftL)	
132 watt	195 cd/m2 (57 ftL)	670 cd/m2 (196 ftL)	
Contrast ratio (full field)	1500:1		
Image alignment	6-Axis servo motor control		
Brightness uniformity	> 90%		
Color and brightness control (optional)	Automatic via SiFi (Set It and Forget It™) Auto Color Balance		
Weight**	125 lbs (67 kg)		
Lamp type	100 watt UHP Long Life Dual auto switching 132 watt UHP High Bright Single		
Lamp life*** (median)	Long life dual	Long life single	High bright single
	20,000 hours (10,000 x 2)	10,000 hours	10,000 hours
Power consumption	< 250 watts		
Serviceability	Full front/Full rear access		
Rear clearance	Zero required		
Colors	16.7 million		
Color gamut	> 70% NTSC, 100% EBU		
Operating temperature	5-30°C (20° +/-3C for optimal screen performance)		
Non-operating temperature	-10°C to 50°C		
Operating humidity	20-80% RH non-condensing		
Safety regulations	FCC Class A, EN55022/CISPR22, ICES-003, CNS 13438, EN55024, EN60950, TUV Rheinland		
Display technology	SmoothPicture™ DLP®		
Data input (standard)	VGA to FHD (1920x1080 @60Hz)		
Analog	DSUB 15 pin connector x2 with loop through		
Digital	DVI-D with loop through		
Video input (optional)	SDI (NTSC/PAL, 720, 1080i) BNCx2 with loop through Composite (NTSC/PAL/SECAM) with loop through S-Video (NTSC/PAL) with loop through Component-HD (NTSC/PAL, 480p-1080p) RCAx3 with loop through		
Ambient noise	40 dB (typical)		
Display control	IR remote, RS-232, RS-485 with loop through		
WallNet™	Supported		
Big Picture	Supported		

*Specified with white boost off. With white boost on brightness would be increased by approximately 17%.

**Weight and dimensions are approximate. Specifications and design are subject to change without notice. This product may be subject to export control regulations.

***Lamp manufacturer specs at IEC 61947-1 test conditions.

Clarity SP Series Connection Panel

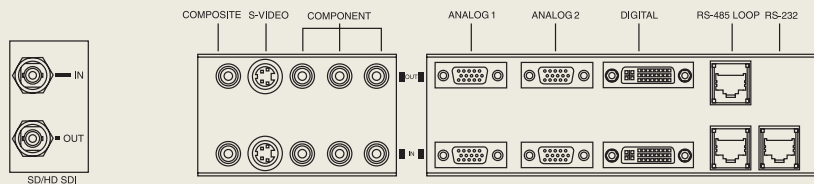

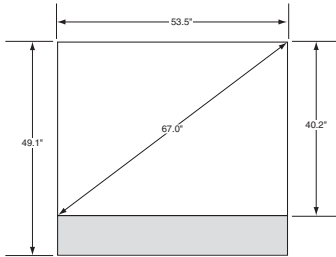

front

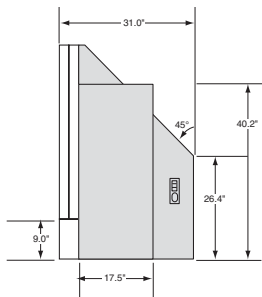

side

Clarity c67SP

Display resolution	SXGA+ (1400 x 1050)		
Aspect ratio (W:H)	4:3		
Screen dimensions			
Diagonal	67" (170.0 cm)		
Width by Height	53.5" x 40.2" (136 cm x 102 cm)		
Cabinet dimensions (WxHxD)	53.5" x 49.1" x 31" (136 cm x 124.9 cm x 78.8 cm)		
Maximum stack height	6 high (requires supplemental support)		
Screen type	Wide-view	High-bright	
Full viewing angle	180°	180°	
Viewing angle (1/5 gain)	+/-70° V/H	+/-18° V; +/-48° H	
Viewing angle (1/2 gain)	+/-38° V/H	+/-10° V; +/-33° H	
Border (typical)	0		
Screen to screen gap	< 0.7 mm		
Brightness* (typical)			
100 watt	70 cd/m2 (20 fL)	250 cd/m2 (72 fL)	
132 watt	110 cd/m2 (32 fL)	390 cd/m2 (115 fL)	
Contrast ratio (full field)	1500:1		
Image alignment	6-Axis servo motor control		
Brightness uniformity	> 90%		
Color and brightness control (optional)	Automatic via SiFi (Set It and Forget It™) Auto Color Balance		
Weight**	190 lbs (86 kg)		
Lamp type	100 watt UHP Long Life Dual auto switching 132 watt UHP High Bright Single		
Lamp life*** (median)	Long life dual	Long life single	High bright single
	20,000 hours (10,000 x 2)	10,000 hours	10,000 hours
Power consumption	< 250 watts		
Serviceability	Full front/Full rear access		
Rear clearance	Zero required		
Colors	16.7 million		
Color gamut	> 70% NTSC, 100% EBU		
Operating temperature	5-30°C (20° +/-3C for optimal screen performance)		
Non-operating temperature	-10°C to 50°C		
Operating humidity	20-80% RH non-condensing		
Safety regulations	FCC Class A, EN55022/CISPR22, ICES-003, CNS 13438, EN55024, EN60950, TUV Rheinland		
Display technology	SmoothPicture DLP		
Data input (standard)	VGA to FHD (1920x1080 @60Hz)		
Analog	DSUB 15 pin connector x2 with loop through		
Digital	DVI-D with loop through		
Video input (optional)	SDI (NTSC/PAL, 720, 1080i) BNCx2 with loop through Composite (NTSC/PAL/SECAM) with loop through S-Video (NTSC/PAL) with loop through Component-HD (NTSC/PAL, 480p-1080p) RCAx3 with loop through		
Ambient noise	40 dB (typical)		
Display control	IR remote, RS-232, RS-485 with loop through		
WallNet	Supported		
Big Picture	Supported		

*Specified with white boost off. With white boost on brightness would be increased by approximately 17%.

**Weight and dimensions are approximate. Specifications and design are subject to change without notice. This product may be subject to export control regulations.

***Lamp manufacturer specs at IEC 61947-1 test conditions.

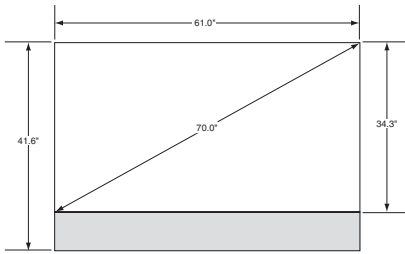

front

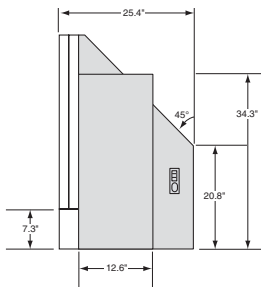

side

Clarity c70SPw

Display resolution	1080p (1920 x 1080)		
Aspect ratio (W:H)	16:9		
Screen dimensions			
Diagonal	70" (177.8 cm)		
Width by Height	61" x 34.3" (154.9 cm x 87.1 cm)		
Cabinet dimensions (WxHxD)	61" x 41.6" x 25.4" (155 cm x 105.6 cm x 64.6 cm)		
Maximum stack height	6 high (requires supplemental support)		
Screen type	Wide-view	High-bright	
Full viewing angle	180°	180°	
Viewing angle (1/5 gain)	+/-70° V/H	+/-18° V; +/-48° H	
Viewing angle (1/2 gain)	+/-38° V/H	+/-10° V; +/-33° H	
Border (typical)	0	0	
Screen to screen gap	< 0.7 mm	< 0.7 mm	
Brightness* (typical)			
100 watt	100 cd/m2 (30 fTL)	360 cd/m2 (105 fTL)	
132 watt	160 cd/m2 (46 fTL)	560 cd/m2 (165 fTL)	
Contrast ratio (full field)	1500:1		
Image alignment	6-Axis servo motor control		
Brightness uniformity	> 85%		
Color and brightness control (optional)	Automatic via SiFi (Set It and Forget It™) Auto Color Balance		
Weight**	165 lbs (75 kg)		
Lamp type	100 watt UHP Long Life Dual auto switching 132 watt UHP High Bright Single		
Lamp life*** (median)	Long life dual	Long life single	High bright single
	20,000 hours (10,000 x 2)	10,000 hours	10,000 hours
Power consumption	< 250 watts		
Serviceability	Full front/Full rear access		
Rear clearance	Zero required		
Colors	16.7 million		
Color gamut	> 70% NTSC, 100% EBU		
Operating temperature	5-30°C (20° +/-3C for optimal screen performance)		
Non-operating temperature	-10°C to 50°C		
Operating humidity	20-80% RH non-condensing		
Safety regulations	FCC Class A, EN55022/CISPR22, ICES-003, CNS 13438, EN55024, EN60950, TUV Rheinland		
Display technology	SmoothPicture DLP		
Data input (standard)	VGA to FHD (1920x1080 @60Hz)		
Analog	DSUB 15 pin connector x2 with loop through		
Digital	DVI-D with loop through		
Video input (optional)	SDI (NTSC/PAL, 720, 1080) BNCx2 with loop through Composite (NTSC/PAL/SECAM) with loop through S-Video (NTSC/PAL) with loop through Component-HD (NTSC/PAL, 480p-1080p) RCAx3 with loop through		
Ambient noise	40 dB (typical)		
Display control	IR remote, RS-232, RS-485 with loop though		
WallNet	Supported		
Big Picture	Supported		

*Specified with white boost off. With white boost on brightness would be increased by approximately 17%.

**Weight and dimensions are approximate. Specifications and design are subject to change without notice. This product may be subject to export control regulations.

***Lamp manufacturer specs at IEC 61947-1 test conditions.

For more information

To learn more about the Clarity SP Series of control room displays by Planar Systems, contact us at 503-748-1100 or visit www.planarcontrolroom.com.